



Truck RFID

NOVEMBER 2024

CMA TERMINALS KHALIFA PORT



TOPICS



RFID Guidelines

- Physical Installation of Tags – How to and tips (External trucks)

- Payment Process , Devices, FAQ.

Installation Guide



Location

- Both RFID tags must be placed at the same location and Height on the left and right sides of the truck.
- Tags should be 230 cm from the ground.
- 60 cm from the window (refer to the photo for the ideal location).

RFID Orientation on the truck

- Please make sure that all RFID tags are mounted as seen on the photo



Step by Step installation



1
Clean truck surface with towel, clear from any dirt



2
Tear off protective film. (pre-package RFID 3M tape)

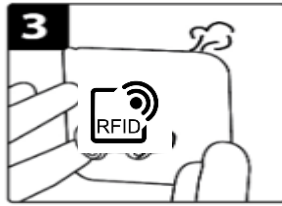

3
Apply the tag firmly on the truck (refer on the location)

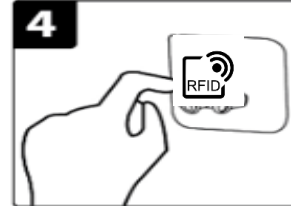

4
Press and hold for 10 seconds to firmly stick the RFID to the truck

Further notes:

Make sure the Left and Right tags are installed in the proper areas of the vehicle.

Removal Procedure: The removal of tags must only be done through CMA TERMINALS KHALIFA PORT. The terminal team will assist with the replacement of tags

Truck Registration and Tagging Process

- 1. Truck Registration:** Ensure all trucks are duly registered with both the ATLP and CMA TERMINALS KHALIFA PORT systems to proceed with terminal access.
- 2. Customer Account Registration:** Complete the CMATK Customer Registration Form to establish your company's profile in our system.
- 3. RFID Setup Request:** Submit a formal RFID setup request, including the total number of trucks requiring RFID registration.
- 4. Account Activation:** Our Finance Department will process your account registration within our billing system.
- 5. Invoice Issuance:** An invoice for the registration fees will be sent to you from the Finance Team.
- 6. Bank Details for Payment:** CMA TERMINALS KHALIFA PORT team will provide the necessary bank details for payment processing.
- 7. Payment Confirmation and RFID Registration:** Once payment is received, RFID tags will be confirmed.

CMA TERMINALS KHALIFA PORT

Customer Registration form

Dear Valued Customer Thanks for choosing CMA TERMINALS KHALIFA PORT. We appreciate your trust in us and look forward to providing you with exceptional service. Please take a moment to provide us with your information. Kindly fill in the required fields in the table below to help us serve you better. Your details are secure and will only be used for the purposes outlined in our privacy policy. Thank you for your cooperation.

(*) Required field

Name *	
Role *	Please pick one of the following options (Line Operator, Agent, Vessel Operator, Customs, Shipper/Consignee, Trucking Company, Others)
Primary Contact Name *	
Primary Contact E-mail *	
Address Line1 *	
City *	
PO Box *	
Country *	
Tel Mobile *	
Tel No 2	
Fax	
Tax ID (TRN) *	
IBAN	
BIC Code	
Invoicing Currency *	

Customer Representative [Company Name]

Customer Representative [Date, Name and Signature]

CMA Terminals Khalifa LLC
Khalifa Port, Al Warqa Street
Abu Dhabi, United Arab Emirates

CMA TERMINALS KHALIFA PORT

Sample Customer registration form